

ISO 9001:2000

Ultra high speed, Take out cycle in the blink of an eye.

SiDE ENTRY

SR-150~350 & SR II-150~350
TOP IV-V-X350~550



SIDE ENTRY

Simple Operation, Better Safety and High Precision Robots.

TOP IV-V Series

SR / SRII Series

- Features**
- >> Injection Molding Machine : For 100 ~ 450 Tons Horizontal
 - >> Application : Low ceiling environment, Thin wall, High speed molding.
 - >> Servo Axis : Maximum 2 Axis
 - >> Motion Guide : High Strength and Low noise LM Guide.
 - >> Side Entry Motion allow to minimize take out cycle time.

Features

Side Entry

Minimize the take out stroke of the robot with the mechanism of the Side Entry from back door side of the molding machine. This structure minimizes take out cycle time in the blink of an eye.

Low Ceiling Clearance

There is no robot arm on the mold. Even low ceiling clearance plant able to install the part takes out automation on molding machines.

AC Servo Motor

High Power and compact servo motors are used to optimize acceleration, deceleration and overall speeds.

Cold Runner or Sprue

This robot can be installed with TOPIV sprue picker robot for 3 Plate mold. (Side Entry for Parts, Sprue for TOPIV Sprue Picker).

Special Vacuum Cylinder Stem

Special Vacuum Cylinder stems help to minimize take out cycle time in the blink of an eye with minimized kick (Reach) stroke.

Model Description

SR - 150

- 1 Molding Machine Tonnage(ton)
- 1 SR : Servo Motor for Traverse Axis, and Pneumatic Cylinder for Kick Motion
- SR II : Servo Motor for Traverse Axis and Kick

Technical Specification

Power	Motion Control	Control Method	Normal Pneumatic Pressure	Maximum Pneumatic Pressure	Chuck Rotation
AC220V or 110V	Pneumatic Cylinder of kick motion	Micro Computer	6 kgf /cm ²	8 kgf /cm ²	90°

Model	Traverse Stroke (mm)	Kick Stroke (mm)	Max. electric consumption	Max. electric consumption [/ (ormal) / cycle	Maximum Handling Capacity
SR /SRII-150	1500	500 (150)	3phase AC220V 6A Max.	7 (11)	Up to 2kgf
SR /SRII-250		620 (150)			
SR /SRII-350		800 (150)			

() SR Type.

TOP IV-V Series

Take out robot for vertical injection molding machine.

For 30~350 Tons Vertical Injection Molding Machines.
Sprue or Parts Pick and Place Robot.
High Speed and Productivity,
Unattended Operation.



Technical Specification

Power	Operation	Control	Normal Pneumatic Pressure	Maximum Pneumatic Pressure
AC220V (50/60Hz)	Pneumatic Cylinder	Microprocessor	6kgf /cm ²	8kgf /cm ²

Model	Stroke (mm)			Reach Position (mm)	Air Consumption [l(normal)/cycle]	Handling Capacity	Weight(kg)
	Reach	Kick	Swing				
TOP IV-V-X350	350	75	Min60° ~ Max90°	100	10	1.2kgf	35
TOP IV-V-X450	450		12		36		
TOP IV-V-X550	550		14		37		

Dimension

Unit : mm

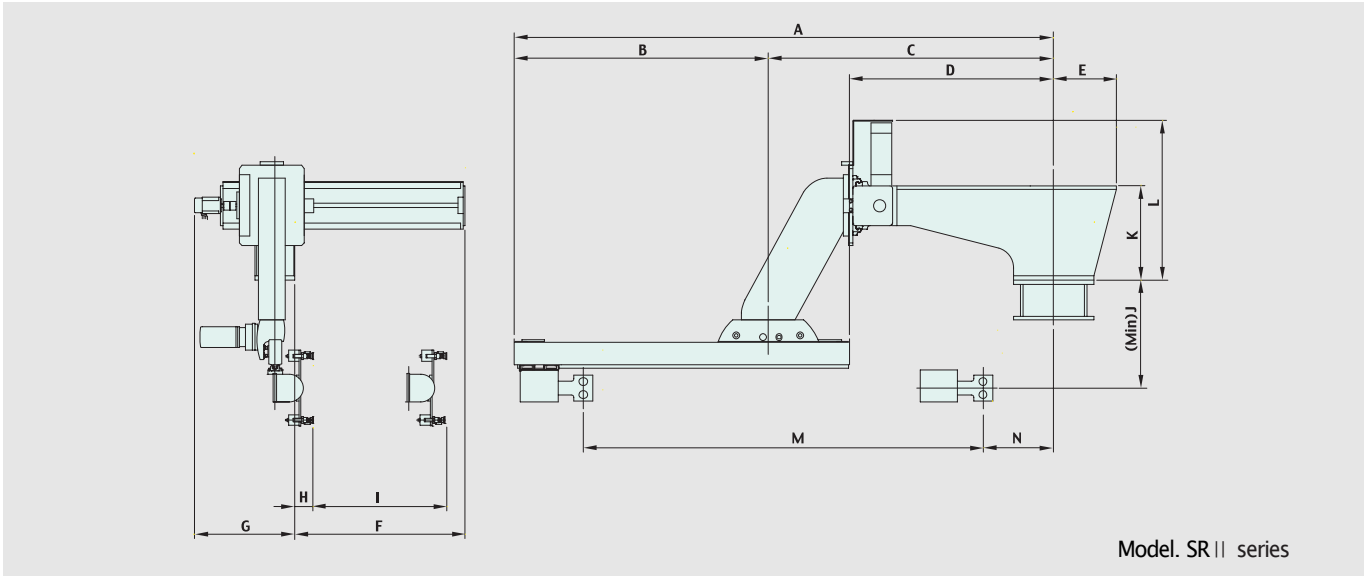

Model	A	B	C	D	E	F	G	H	I	J	K	L	M	N
SR/SR II - 150	2025	955	1070	766	235	636	379	70	500	250	355	600	1500	265
SR/SR II - 250	2125		1170	866		756			620	350				365
SR/SR II - 350	2465	1195	1270	966		936			800	420			1195	465

All information is subject to change without any notice.

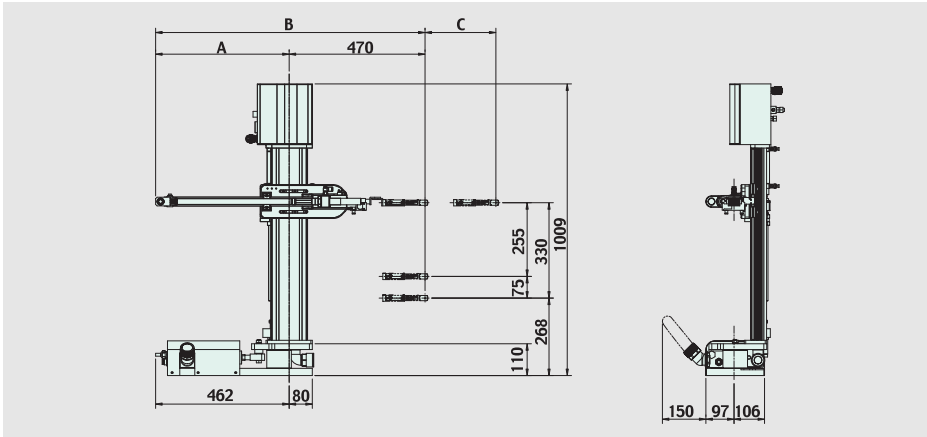

Model	A	B	C
TOP IV-V-X350	362	832	350
TOP IV-V-X450	462	932	450
TOP IV-V-X550	562	1032	550



HYRobotics Co. Ltd.
 173-228, Gajwa-dong, Seo-gu,
 Incheon-si, Korea
 TEL: 82-32-582-5040,
 82-32-582-5046
 FAX : 82-32-584-7040
 www.hyrobot.com

HYROBOTICS CORP.
 5988 mid Rivers Mall Dr.
 Saint Louis, MO 63304 USA
 TEL: 1-636-578-6059
 FAX: 1-866-232-5594
 www.hyrobot.com